

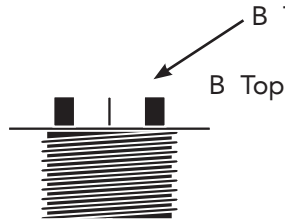

Understanding ScrewJack Patent and Patent Improvements Pending

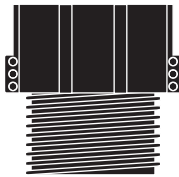

Bison Screwjack B Series Pedestals are packaged with the top and base fully assembled in the pedestal's lowest height position. To increase the height, simply unscrew. DO NOT extend the height of the pedestal past the built-in thread engagement indicators (bumps) unless adding a coupler.



C4 Coupler

To increase the height, continue to unscrew the top and base past the thread engagement indicators until they separate. The insert a C4 coupler between the top and base and reassemble making certain that they are screwed past C4 thread engagement indicators (bumps).



B Base

Simply screw or unscrew the C4 coupler maintaining equal thread engagement between the top and bottom coupler for maximum strength.

Bison Screwjack B Series Pedestals support plaza pavers on a structurally supported surface. Each pedestal utilizes a patented screwjack design that allows the installer to easily adjust the height of the pedestals - even when loaded.

Integrated spacer tabs ensure accurate spacing, restrain paver movement and allow water to drain. Placed over the waterproofing surface without penetrating it, they support plaza pavers with ease.

Available exclusively through WESTILE, Bison Screwjack B Series adjustable pedestals are made of durable, high density polypropylene and are impervious to water, mold and most chemicals. Screwjack B Series pedestals support up to 1,000 lbs. per pedestal with a factor of safety of two FS:2 and with couplers reach a maximum height of 16 inches. Accessories are available to compensate for slope and low height applications from 1/8 inch to 2 inches.

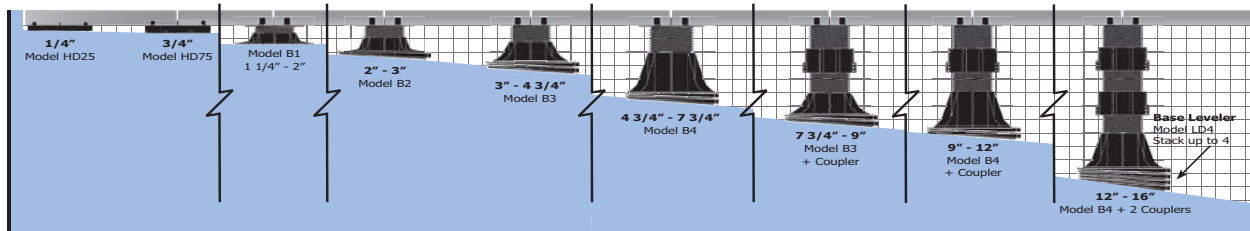

Maintenance Guide

Routine maintenance of your paver deck system will enhance the appearance and utility, reduce major repairs, and prolong the life of your deck. Below is a list of maintenance guidelines that should be performed on a regular basis:

1. Check for "rocking" pavers. If you notice pavers rocking back and forth while walking on the deck simply lift paver up and shim 1 or more corners until paver is level and fully supported on all four corners. To ensure pedestal stability, make sure they are not extended past the thread engagement indicators. Bison B11 (1/16") or PS1 (1/8") accessories are available for shimming.
2. Depending on substrate materials some settling and or deflection can occur. Remove paver and adjust the pedestal by turning the base or top until level height is achieved. You may need to do this on more than one pedestal to level out an location.
3. Clean drains and through wall scuppers on an annual basis. Water should completely drain off roof deck within 48 hours after rainfall, under ambient drying conditions. Standing or "ponding" water can be detrimental to some waterproofing systems.
4. Check to be sure spacer tabs are located between pavers and replace broken spacer tabs immediately. Loss of spacer tabs can create unsafe deck movement. Bison deck systems must be tightly spaced, contained and completely blocked in to restrain the system on all sides.
5. Inspect and make sure edge restraint stays intact and in good condition. There should be no more than one 1/8" space between the deck and edge restraint at all perimeters.
6. Follow paver manufacturers' suggestions for upkeep and maintenance of pavers.

Copyright © 2013, United Construction Products, Inc. All Rights Reserved

SCREWJACK
Adjustable Deck Supports

Installation Details

May 2013

Advanced Layout and Pedestal Placement

Acronym	Definition
LP	Low Point
HP	High Point
RD	Roof Drain

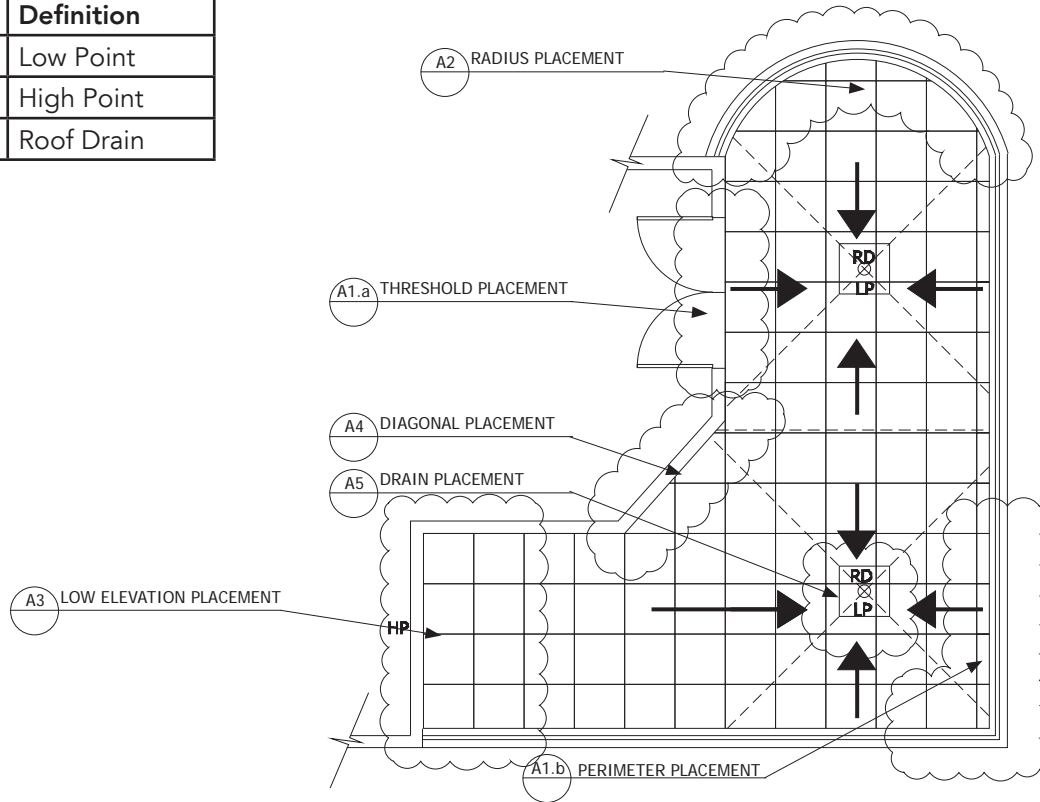

"T" Method Installation

1. Determine cavity height at all thresholds, drains and high points.
2. Deduct thickness of decking material.
3. Mark top of pedestal elevation around deck with laser level
4. Plan paver/pedestal layout pattern
5. Install "T" shaped portion of deck starting from threshold or high point
6. Adjust to correct height and level.
7. Installation on both sides of the "T" can proceed.

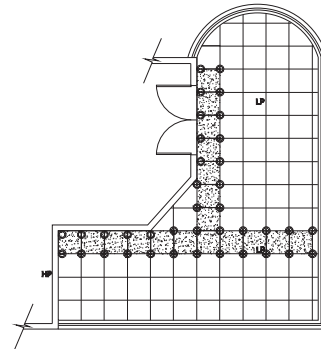

Determining Cavity Height

- The cavity height is the space between the top of the roofing membrane, and the bottom of the decking material.
- Use of a laser level or chalk line may assist.
- Also refer to the detachable measuring device printed on the box.

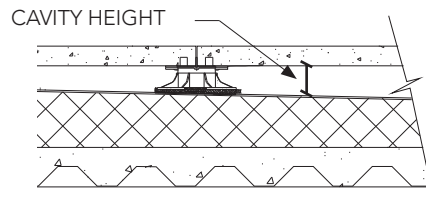

A1 (a) Threshold and (b) Perimeter Placement

- Remove tabs as necessary to inset edge pedestals.
- Turn pedestal upside-down or trim the base for tight fits.
- Never allow more than 1/8 inch between the decking material and edge containment.
- Pedestals may be inverted for particularly tight fits.
- Tabs may be glued into place with construction adhesive to ensure spacing when "normal" tab placement is not possible.

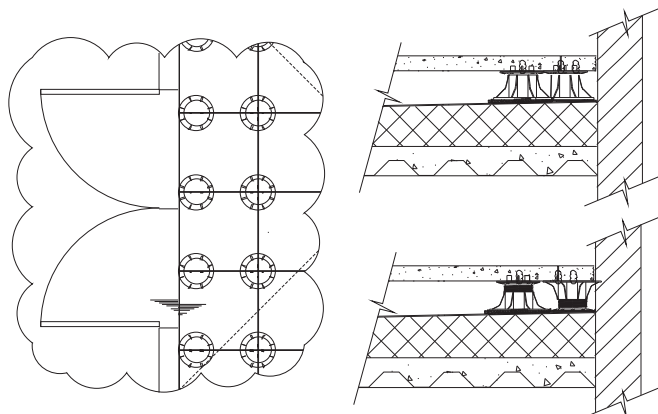

Copyright 5-1-2013 United Construction Products, Inc. All Rights Reserved

A2 Radius Placement

- Use extra pedestals under triangular pieces to prevent rocking.
- Never allow more than 1 tab width between the decking material and edge containment.
- Add an extra pedestal at perimeter bends.
- Remove extra tabs to inset pedestals.
- Adhere small pavers to top of pedestal with construction adhesive.
- Turn pedestal upside-down or trim pedestal base as needed to fit around perimeter.
- Use removed tabs to maintain spacing between pavers.

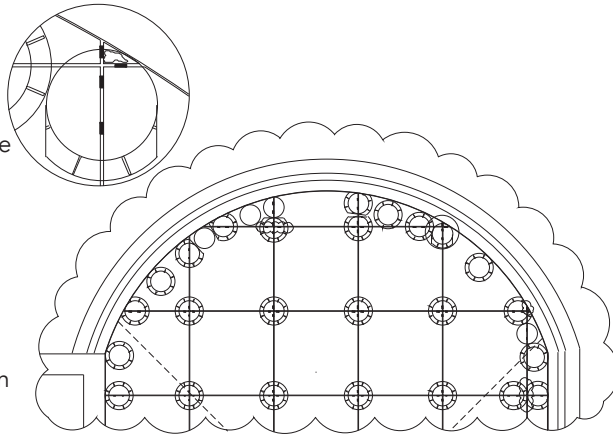

A3 Low Elevation Placement

For low elevations the following pedestals are available:

LOW HEIGHT PEDESTALS

Model:		Height:
VT316	●	1/8"
HD25-316	○	1/4"
HD50-316	●	1/2"
HD75-316	⊗	3/4"
LO-316	⊗	1¼ - 2"

Shims can also be used to accommodate variations in height, in either 1/8" (PS1) or 1/16" (B11) increments.

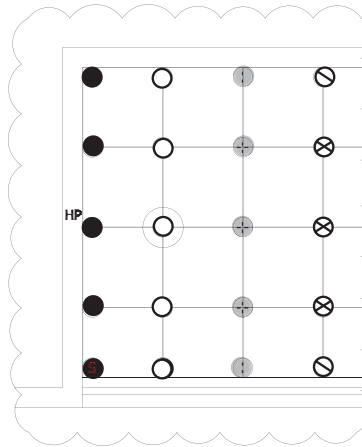

A4 Diagonal Placement

- Use extra pedestals under triangular pieces to prevent support small pieces.
- Never allow more than 1/8 inch between the decking material and edge containment.
- Remove extra tabs to inset pedestals.
- Adhere small pavers to top of pedestal with construction adhesive.
- Trim pedestal base as needed to fit around perimeter.
- Use removed tabs to maintain spacing between pavers.

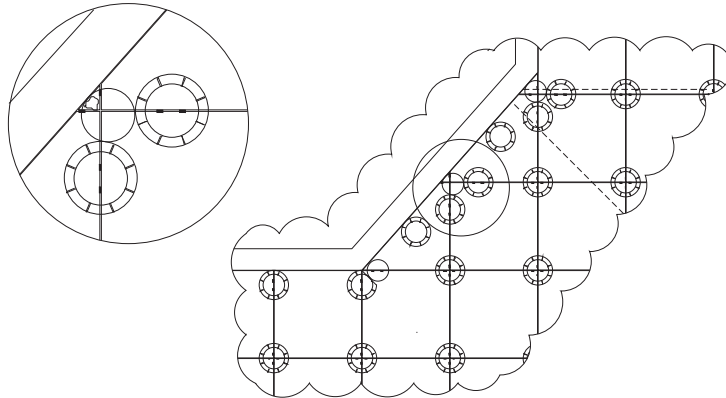

A5 Drain Placement

- Elevate a steel plate or paver above the drain, but below the deck itself.
- Use that elevated plate or paver to support a pedestal where you need for the deck above.

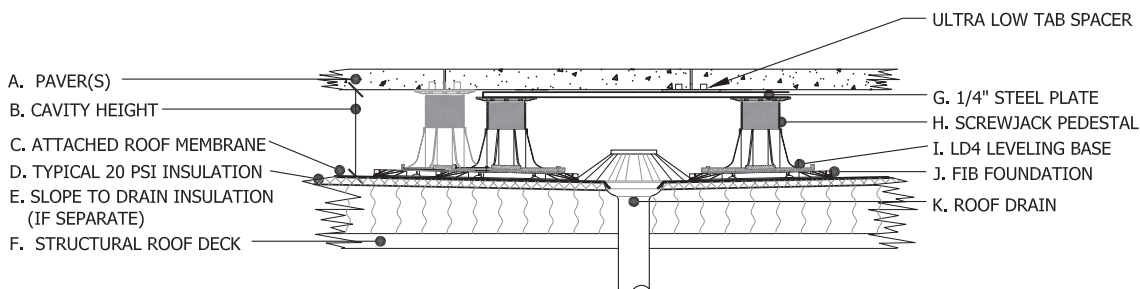
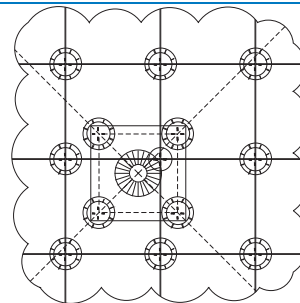

Copyright 5-1-2013 United Construction Products, Inc. All Rights Reserved

Slope Compensation

Base Leveler

Each LD4 compensates for 1/4" per foot (2%) slope and adds 3/8" to the overall height of the pedestal. A maximum of four (4) LD4s may be used to compensate for up to 1" per foot (0-8%) slope.

Place each LD4 on substrate with smooth side down. Center pedestal or additional LD4's between tabs on top. Do not use more than four (4) LD4's under a pedestal.

Finger tab points downhill for 1/4" per foot (2%) slope when using a single LD4.

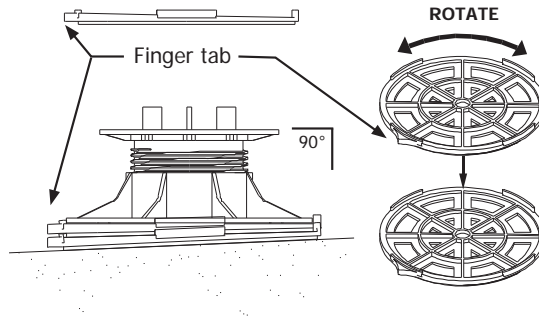

Working with Shims

PS1 (1/8") SHIMS - Rigid

PS1s may be placed on top of pedestals to accommodate for minor leveling of pavers with thickness variations. Use no more than 2 shims. If using only 1/4 segment, adhere it to the pedestal with construction adhesive.

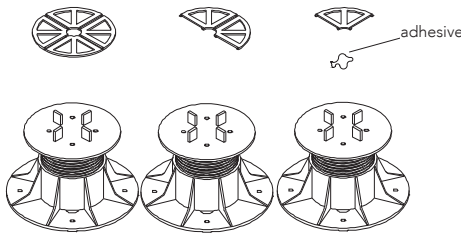

B11 (1/16") SHIMS - Rubber

B11s may be placed on top of pedestals to accommodate for minor leveling of pavers with thickness variations. Use no more than 2 shims. If using only 1/4 segment, adhere it to the pedestal with construction adhesive.

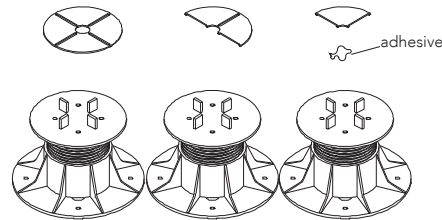

B11 Shims under pedestals

Place shims (whole or in segments) under the pedestal in a stairstep fashion to compensate for sloping substrates. Use only B11 shims for this application. Use no more than four (4) shims.

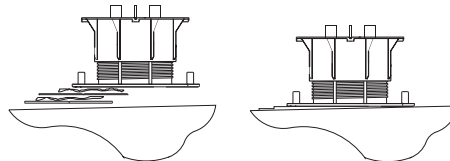

Pedestal Base Pads

Floating Insulation Base (FIB)

If common roof insulation is installed immediately below the membrane, the type and density of the insulation is of utmost importance. For roofing systems having "common" insulations with a medium density of 20 psi Bison recommends using the Bison Floating Insulation Base (FIB). FIBs are installed immediately below the Bison Deck Support pedestals to disperse the deck load. Please refer to specifications for proper use.

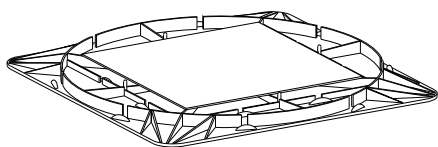

Floating Foundation Base (FFB)

Bison Floating Foundation Bases (FFB) must be used beneath all on grade Bison Deck Support decks. Level the surface and install directly on grade as a base.

